



COUNTRYMAN
H7 HEADSET

Contents

The H7 Headset Microphone	2
Microphone Care	3
Fitting the H7 Headset	4
Positioning the Microphone	5-6
Switching the Microphone Side	7
Snap-On Cables	8
Water-Resistant Windscreen	8
Collar Clips	9
Accessories and Replacement Parts	10
Declarations	11



Thanks for choosing the Countryman H7 Headset.

Our toughest directional microphone yet, the precision side-address pattern of the H7 captures your performance and shuts out feedback and surrounding noise.

This booklet describes how to use and protect your H7 to get the best performance.



Microphone Care

The H7 Headset is designed for exceptional audio clarity and durability. Following some basic guidelines will ensure you get maximum performance from your H7 Headset for years to come:

- Avoid touching the end of the capsule with fingers or obstructing the mesh opening with foreign substances.
- The cable, boom, and frame may be cleaned with alcohol wipes or soap and water. Do not use other solvents or cleaners. Do not use water or any chemicals on the capsule itself.



Fitting the H7 Headset

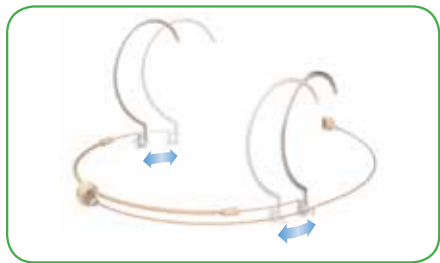

Adjust the earwires for your head size. The headset should feel snug without pinching. If the H7 feels loose on the head, slide the earwires back to tighten the fit.

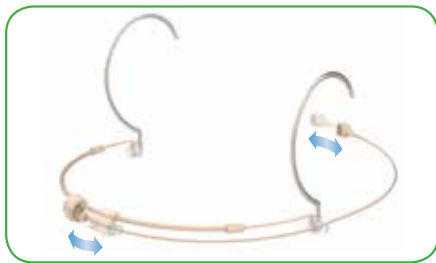

Slide the boom to reach your mouth. You may need to take the headset off momentarily to slide the boom exactly where you want it, then put the headset back on.

Positioning the Microphone



The capsule should rest on or just off the skin and about 0.25" to 0.5" back from the corner of your mouth when smiling.



To avoid breath noise, you may wish to position the microphone slightly below the mouth line.

We recommend that you use the windscreen to address wind noise.

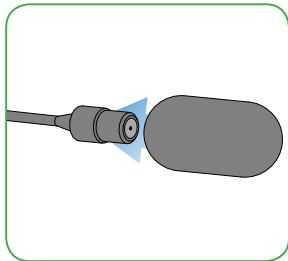

Positioning the Microphone (cont.)



If the capsule is too far back, you will not get the maximum isolation from your microphone.



If the capsule is too far forward, you will get breath pops.



Be careful not to press the tip of the mic into your cheek, as this will muffle your sound.

Switching the Microphone Side

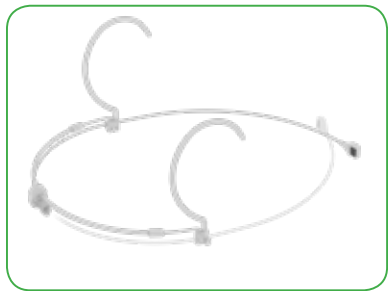

The mic boom detaches from the frame and can switch to either the left or right side: first, remove the boom as shown to the right. Then, place it on the opposite side.

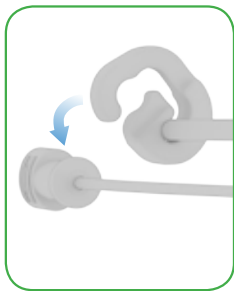

Unclip the boom from the clips along the back of the headset.

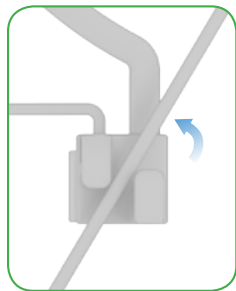

Tip the boom to remove it from the hooks on the earwire.

Snap-On Cables

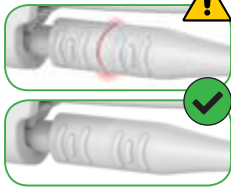

Press the H7 Snap-On Cable firmly into the boom connector until there is no visible gap. The connector will not release accidentally.

Choose an H7 Snap-On Cable to match your wireless transmitter, portable recorder, or XLR input with phantom power.



The H7 Snap-On Cable is tightly-sealed against moisture and dust.



The H7 Cable uses Aramid strength members and engineered alloys for extreme tensile and flex strength. Do not use solvents to clean the cable—only soap and water, or isopropyl alcohol.

Water-resistant windscreen



The H7 Headset includes a water-resistant windscreen coated with a superhydrophobic nanocoating to repel water and sweat. This coating is robust but may lose some of its properties after repeated washing. Use only soap and water when cleaning the H7 windscreen.

Collar Clips

The H7 Headset includes two collar clips—one black, and one white—that provide strain relief for the cable. By using a collar clip, even if your mic cable gets tugged, the mic itself will remain securely in place on your head.

Push the cable into the gripper on the collar clip then loop it back into your shirt or down your back to the transmitter. Remember to leave enough slack in the cable so that you can turn your head to both sides without pulling on the mic.



Accessories and Replacement Parts

Accessory Name

- ① H7 Collar Clip
- ② H7 Snap-On Cable
- ③ H7 Headframe
- ④ H7 Back Mic Clip
- ⑤ H7 Front Mic Clip
- ⑥ H7 Mic Boom

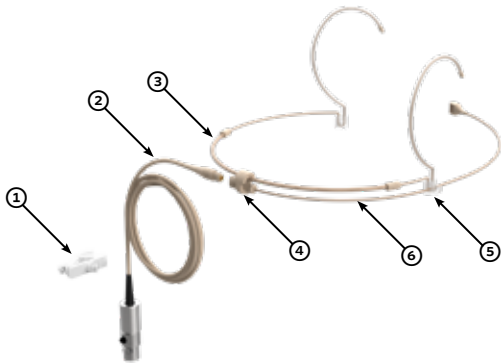

Declarations

We, Countryman Associates Inc., declare under our sole responsibility that the following product:

H7 Headset

To which this declaration relates is in compliance with the essential requirements of:

2004/108/EC	EMC
EN 55103-1	
EN 55103-2	
2002/96/EC	WEEE
2003/108/EC	
2011/65/EU	RoHS

When used as specified.





Countryman Associates, Inc. 195 Constitution Drive, Menlo Park, CA 94025

Phone: (800) 669-1422 or (650) 364-9988 Fax: (650) 364-2794

Email: sales@countryman.com Web: www.countryman.com